

MANUAL

Welcome_KAIST Manual

Android

Information & Communication Team

MANUAL

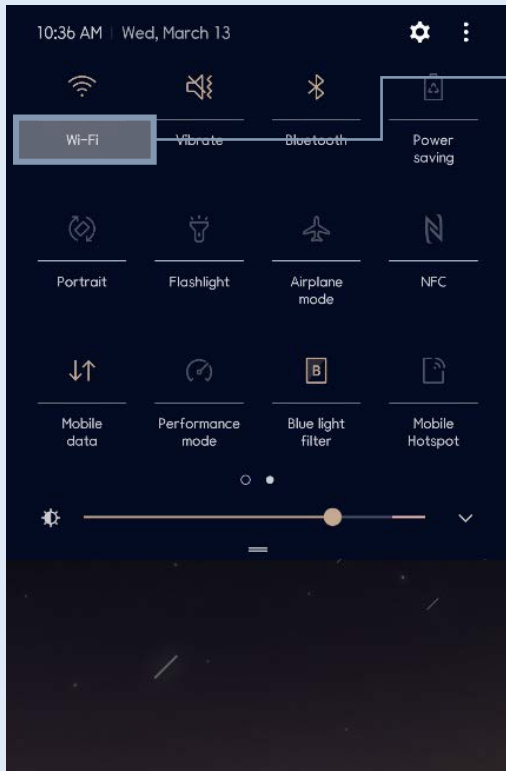

1. Wi-Fi 리스트 보기
1. Show Wi-Fi list

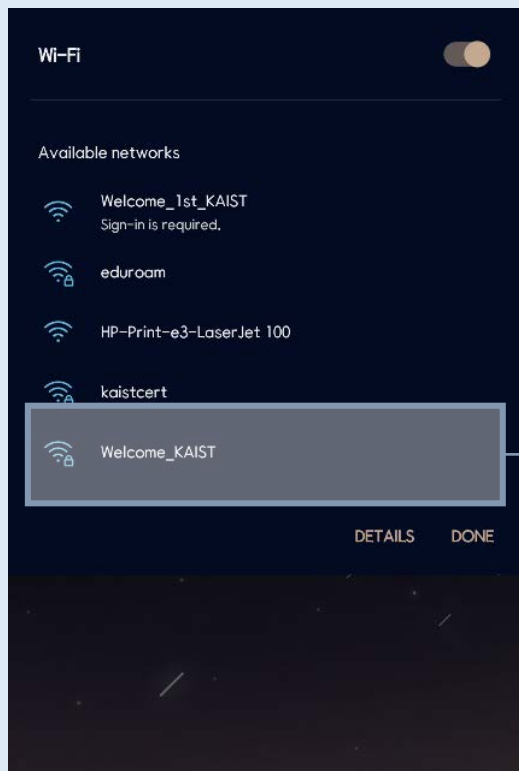

2. Wi-Fi 목록 중 Welcome_KAIST 선택
2. Select "Welcome_KAIST" at Wi-Fi list

MANUAL

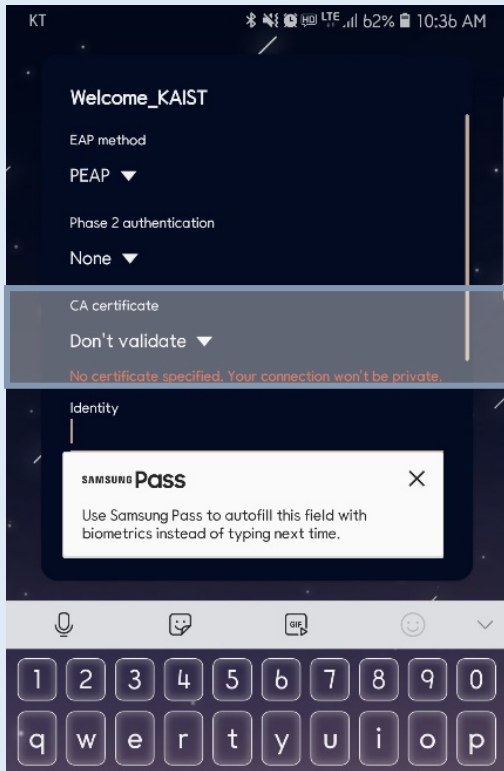

- 3. CA 인증서 “인증 안 함” 선택
- 3. CA certificate “Don't validate”

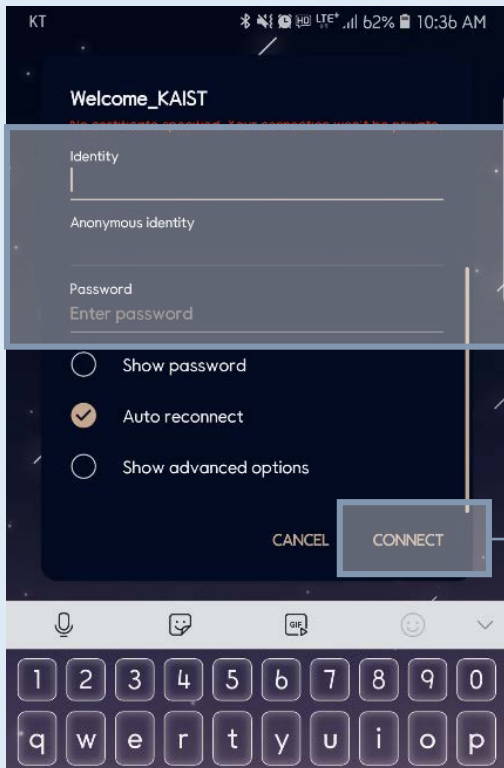

- 4. ID/PW 입력(익명 ID 무시)
- 4. Insert ID/PW (ignore anonymous ID)

- 5. 연결
- 5. Connect

※ 계정 발급 필요 (<https://rd.kaist.ac.kr>)
※ Register account (<https://rd.kaist.ac.kr>)

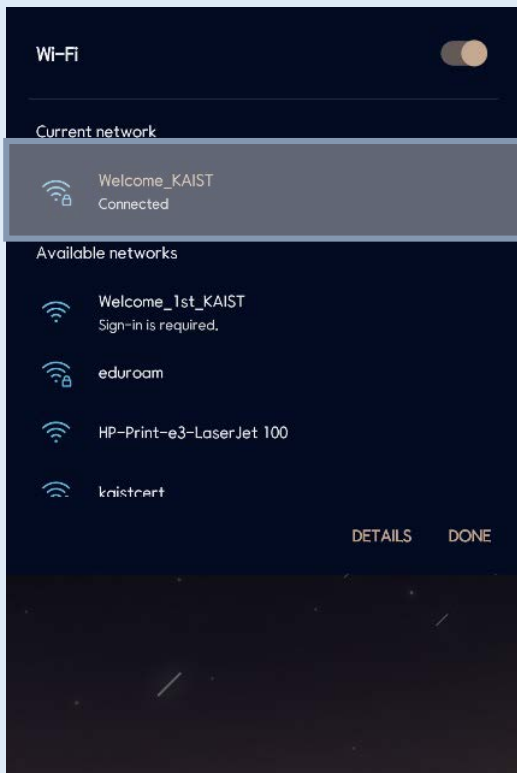

6. 연결 확인
6. Check the connection